

Community hub with library in the heart of town

The new Pookeno community hub with library and Council customer services is a priority identified in the Council's Long Term Plan and the Pookeno Public Realm Concept Plan 2022.

Council's recent purchase of 16 Market Street and 11 Regina Street provide an opportunity to relook at location options and better connect the community hub and library at the heart of the town centre.

We're underway with a feasibility study to determine what services and activities the facility would need to offer to meet the current and future needs and aspirations of our community; the location options; and what a new facility might look like.

As part of the co-design approach, we've taken what the community told us in the co-design workshop in February to:

- Understand current, potential and future services – what you would like to be able to do in the community hub and library
- Develop project principles for the community hub and library
- Develop draft site layout options and spatial plan options

Now we're seeking community input to help determine a preferred option. Come along to the co-design workshop on Monday 29 April, 4.30pm to 6.30pm at the Pookeno Hall.



You're invited to co-design Workshop #2

Monday 29 April, 4.30pm to 6.30pm at the Pookeno Hall.
Come along and help us to determine a preferred option.

Site Layout - Option 1

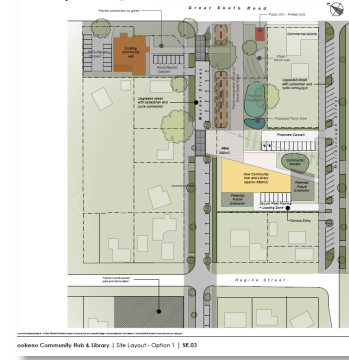

Site Layout - Option 2

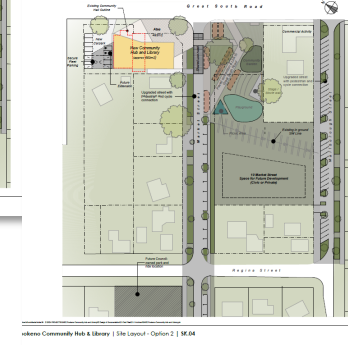

Site Layout - Option 3



Project principles: the community hub and library will be...

These project principles evolved from the co-design workshop in February. The words in brackets are corresponding themes from the Pookeno Public Realm Concept Plan.

Welcoming (Community)

Welcome for all ages, abilities, ethnicities, and cultures. Everyone can access the hub, and its services, with ease and dignity.

Whaanau and community friendly

A place for whaanau and friends to gather, connect and build lifelong memories. Think: "Let's grab an ice cream and meet at the hub"

Proudly Pookeno (Identity)

Celebrating Mana Whenua and the diverse identities of Pookeno and its rural catchment, strengthening a sense of place and sharing local stories, histories and connections.

Alive (Community)

The hub will be a high-quality facility and space that encourages diverse and inclusive activities, well connected to the rest of the town centre and the town.

Partnerships

We will explore and be open to working in partnership with others to deliver the hub and to ensure the services in the hub meet the needs of the community.

Future proofed (Growth)

Will serve the community now and be future proofed for future generations.

A great community investment

It will be flexible in design and operation to maximise use, and meet the needs of many e.g., school, elderly, workers (co-working spaces).

How you want to feel in the community hub and library...

People at the co-design workshop said when using the community hub and library they want to feel:

A word cloud of feelings and values. The word 'Welcome' is the largest and most central. Other words include 'Connected', 'Safe', 'Excited', 'Positive here...', 'Warm and friendly', 'Cohesive', 'Inspired', 'Clean', 'Happy', 'Respected', 'Manaakitanga', 'Love', 'Knowledgeable', 'Better off', 'Accommodated', 'Be relevant!', 'Ours', and 'Inclusive'.