

Appendix One: Certificate of Title for Lake Kainui Local Purpose Reserve

References

Prior C/T 313/16

Transfer No.

N/C. Order No. H. 420031.1

Land and Deeds 69



No. 28A / 1306

CERTIFICATE OF TITLE UNDER LAND TRANSFER ACT

This Certificate dated the 19th day of July one thousand nine hundred and eighty two under the seal of the District Land Registrar of the Land Registration District of SOUTH AUCKLAND

WITNESSETH that THE WAIKATO COUNTY COUNCIL a body corporate is seized of an estate in fee simple for the purpose of a local purpose reserve (esplanade) subject to the Reserves Act 1977

is seized of an estate in fee simple (subject to such reservations, restrictions, encumbrances, liens, and interests as are notified by memorial underwritten or endorsed hereon) in the land hereinafter described, delineated with bold black lines on the plan hereon. be the several admeasurements a little more or less, that is to say: All that parcel of land containing 3.3550 HECTARES more or less being Lot 2 on Deposited Plan S.24905 and being part Allotments 229 and 230 Parish of Komakorau

Bik. V Komakorau S.D.

ASSISTANT LAND REGISTRAR

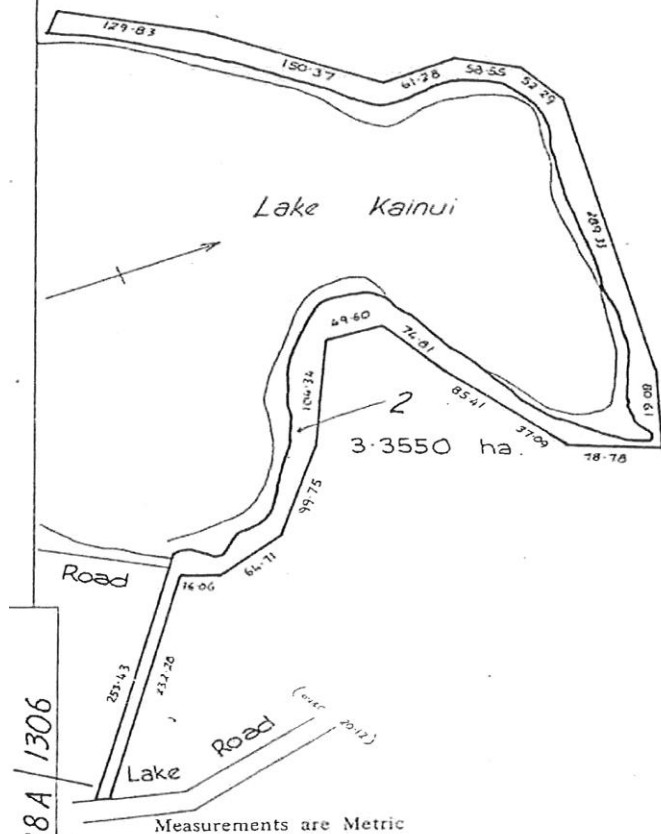

No. 28A / 1306

Appendix Two: Gazette Notices and Legal Description

Extract from N Z Gazette, 31 July 1980. No. 89, page 2268

Reservation of Land and Vesting in the Waikato County
Council

Pursuant to the Land Act 1948, and to a delegation from the Minister of Lands, the Assistant Commissioner of Crown Lands, hereby sets apart the land, described in the Schedule hereto, as a reserve for recreation purposes, and further pursuant to the Reserves Act 1977, vests the said reserve in the Waikato County Council in trust for that purpose.

SCHEDULE

South Auckland Land District-Waikato County

3.8000 hectares, more or less, being Allotment 338 (formerly Part Allotment 59 and Crown Land), Komakorau Parish, situated in Block V, Komakorau Survey District, All New Zealand Gazette, 1980, page 24. S.O. Plan 50902.

Dated at Hamilton this 18th day of July 1980.

G.L. VENDT, Assistant Commissioner of Crown Lands.

(L. and S. H.O. Res. 3/2/297: D.O. 3/2012)

Appendix Three: Certificate of Title for Lake Kainui Recreation Reserve

References

Prior C/T
Gazette Notice H.302938
Transfer No.
N/C. Order No. H.307147.2

Land and Deeds 69



No. 26 B / 876

CERTIFICATE OF TITLE UNDER LAND TRANSFER ACT

This Certificate dated the 22nd day of September one thousand nine hundred and eighty under the seal of the District Land Registrar of the Land Registration District of SOUTH AUCKLAND

WITNESSETH that THE WAIKATO COUNTY COUNCIL a body corporate is seized of an estate in fee simple as a reserve for recreation purposes

~~is seized of an estate in fee simple~~ (subject to such reservations, restrictions, encumbrances, liens, and interests as are notified by memorial underwritten or endorsed hereon) in the land hereinafter described, delineated with bold black lines on the plan hereon, be the several admeasurements a little more or less, that is to say: All that parcel of land containing 3.8000 HECTARES more or less being Allotment 338 Parish of Komakorau



[Signature]
ASSISTANT LAND REGISTRAR

The within land has no road frontage

Subject to the Reserves Act 1977

[Signature]
A.L.R.
[Signature]
A.L.R.

Blk V Komakorau S. D.

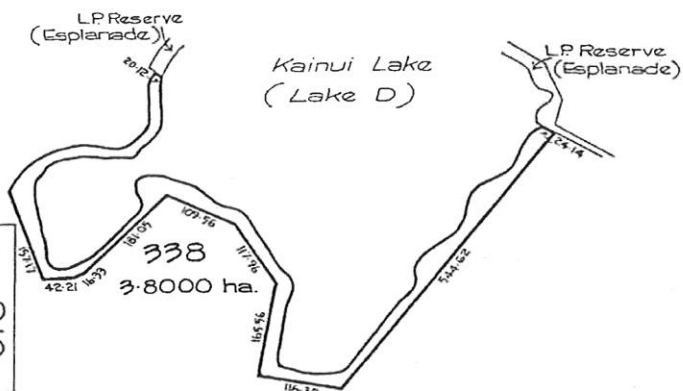

S.O. 50902

Measurements are Metric

[Signature]
J.E.G.

No. 26 B / 876